

of

located in the Southeast 1/4 of Section 21, Town 2 North, Range 16 East, Town of Delavan, Walworth County, Wisconsin.

605 Southpoint Drive
Schaumburg, Illinois. 60172

c/o

701 East Walworth Avenue
Delavan, Wisconsin. 53115

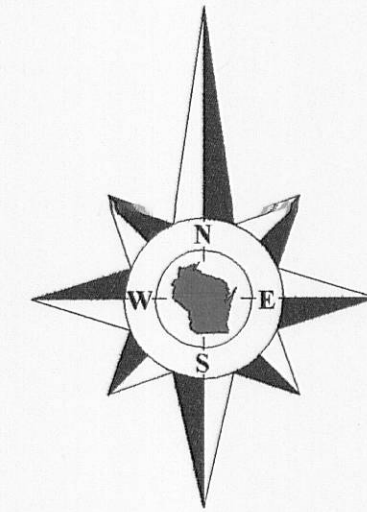

Bearings referenced to the plat of
Villa Schweyer Subdivision.

Survey Date: April 6, 2011.
Revisions: No. 1 – Proposed Decks and Steps

Scale in Feet
1" = 10'



Jensen & Olson Land Surveying, LLC

Wisconsin Street * P.O. Box 322 * Elkhorst, Wisconsin. 53121
Telephone: (262) 723-3434 * Facsimile: (262) 723-8044

Email: jensen.olson@elknet.net

Legend

Ø Found Iron Pipe
() Recorded Information
Ø Utility Pole
Asphalt Surface
Concrete Surface

Sheet 1 of 1 Sheets
Drawing Name: t2nr15e-2011015-2011015SP
Job Reference Number
2011.015

2011.015

RECEIVED
MAY 18 2011
By *SMF*

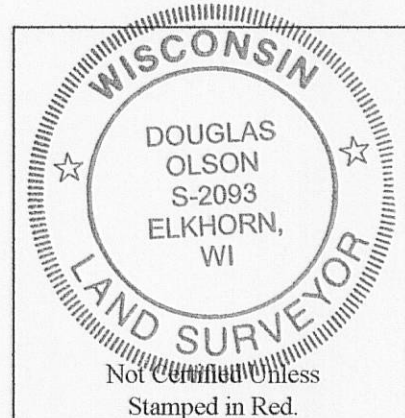

Notes:

- 1) This survey plat is not ~~certified unless signed~~ and sealed in red ink.
- 2) This survey is subject to Wisconsin lien laws. This Plat of Survey is the notice of intent to file lien. Lien waiver required.

Copyright 2011 by Jensen & Olson Land Surveying, LLC.

All rights reserved. No part of this survey plat may be reproduced or transmitted in any form by any means - graphic, electronic, or mechanical, including photocopying, tracing, or information storage and retrieval systems - without permission in writing from Douglas G. Olson, Jensen & Olson Land Surveying, LLC.

I, Douglas G. Olson, Wisconsin Registered Land Surveyor, do hereby certify that this survey was performed by me, or under my direction in full compliance with the owner's/agent's instructions and Chapter A-E 7 of the Wisconsin Administrative Code "Minimum Standards for Property Surveys"; and that this map is an accurate representation thereof to the best of my knowledge and belief.

Douglas G. Olson
Wisconsin Registered Land Surveyor - 2093

FVS - 9

216-4854